

# VMax

## High-Speed Vertical Hand Dryer

Secamanos vertical de alta velocidad  
Sèche-mains vertical haute vitesse



### All V Series

Todos los modelos de la serie V  
Série V complète

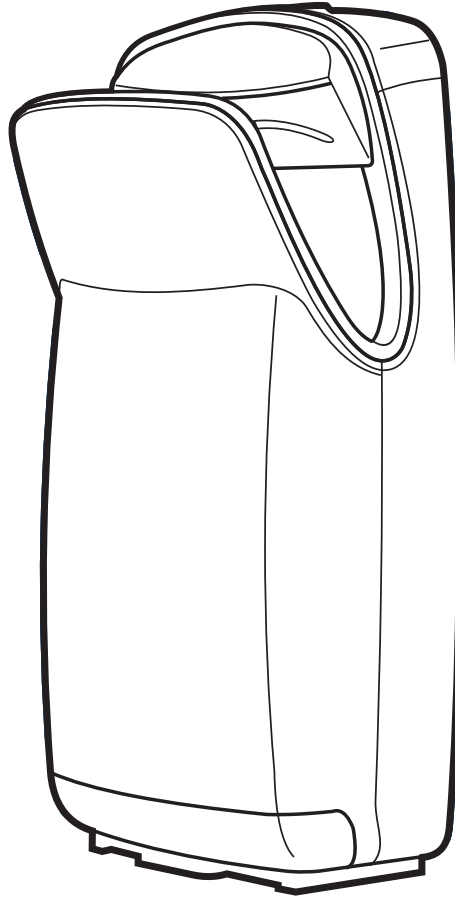

**Please read and save these instructions. Read carefully before attempting to assemble, install, operate or service the product described. Protect yourself and others by observing all safety information. Failure to comply with instructions could result in personal injury and/or property damage. Retain instructions for future reference.**

Por favor lea y guarde estas instrucciones. Léelas cuidadosamente antes de tratar de montar, instalar, operar o dar mantenimiento al producto aquí descrito. Protéjase usted mismo y a los demás observando toda la información de seguridad. No seguir las instrucciones puede ocasionar daños, tanto corporales como materiales. Guarde estas instrucciones para referencia en el futuro.

Lire et conserver ces instructions. Les lire attentivement avant de commencer à assembler, à installer, à faire fonctionner ou à entretenir l'appareil décrit. Pour se protéger et protéger autrui, observer toutes les consignes de sécurité. Négliger de se conformer à ces instructions peut causer des blessures personnelles et/ou des dommages matériels. Conserver ces instructions pour références ultérieures.



**WORLD DRYER**

**World Dryer Corporation**

340 County Line Road  
Bensenville, IL 60106 U.S.A.

Distributed by  
[www.Ameraproducts.com](http://www.Ameraproducts.com)  
Phone: (800) 608-6568  
Fax: (409) 840-5545  
[info@ameraproducts.com](mailto:info@ameraproducts.com)

## Description

World air hand dryer is a surface-mounted ADA (American Disabilities Act) compliant dryer powered by a universal brush motor, and delivers 1200 watts of drying power. The dryer incorporates a replaceable HEPA filter and replaceable odor neutralizing tablet. An infrared sensor is used to automatically activate the dryer. These models are intended for use in commercial, industrial, office and public facility environments.

## Electrical Specifications

**Table 1**

Models	Type	Electrical Input	Rated Amperage	Rated Watts	Certifications
V-XXXX	Automatic	120V, 60 Hz	10.0A	1200	

## General Safety Information

**⚠ DANGER** Failure to disconnect the power source before installation or servicing can result in serious injury or death from electric shock.

- Always disconnect the power source before servicing or installing the hand dryer.

**⚠ WARNING** Risk of fire, electric shock, personal injury or property damage are possible if local codes, or safety recommendations are not followed.

- Use only for drying hands as intended by the manufacturer. Do not use hand dryer for any purpose other than drying hands.
- Carefully follow all instructions for installation on the enclosed mounting template / instructions.
- Installation should only be performed by qualified persons in compliance with all applicable federal, state and local codes and standards.
- When cutting or drilling into wall or ceiling, do not damage electrical wiring and other hidden utilities.
- Connect the hand dryer to the nearest suitable distribution panel. The fixed wiring must include a disconnection means complying with local wiring codes.
- To limit a voltage drop, and insure efficient operation, use No. 14 AWG or larger as required by local electrical codes.
- Always connect to a branch circuit with circuit breaker or fuse protection with an electrical rating greater than the model hand dryer's rated amperage shown in Table 1 - Electrical Specifications in accordance with the NEC (National Electrical Code) and/or CEC (Canadian Electrical Code).
- Use only the electrical power (voltage and frequency) specified for the model hand dryer being installed. See Table 1 - Electrical Specifications
- To avoid a hazard due to inadvertent resetting of the thermal cutout, the hand dryer must not be supplied through an external switching device, such as a timer, or connected to a circuit that is regularly switched on and off by the utility.
- Each hand dryer must have a dedicated circuit.
- For indoor use only. Do not use outdoors. Do not expose to rain, sun or extreme temperatures. Do not use near sources of water or extreme heat.
- Repair work should only be performed by World Dryer or World Dryer authorized service representatives.
- This appliance is not intended for use by persons (including children) with reduced physical, sensory or mental capabilities, or lack of experience and knowledge, unless they have been given supervision or instruction concerning use of the appliance by a person responsible for their safety.

**⚠ WARNING** Risk of fire, electric shock, personal injury or property damage are possible if the following safety precautions are not followed.

- Do not use hand dryer for any purpose other than drying hands.
- Repair work should only be performed by World Dryer or World Dryer authorized service representatives. Only use genuine replacement parts.
- Do not insert foreign objects in or on the unit.
- Do not place heavy objects on the unit.
- Do not use in corrosive environments.
- Do not use in explosive atmospheres.
- Do not use in extremely humid locations or near sources of water.
- Do not immerse appliance in water or other liquid.
- Children should be supervised not to play with the appliance.
- Disconnect from the power supply before servicing.

**⚠ WARNING** When you dispose of an old appliance or any components, follow any local and national laws on disposal of electronic waste. This appliance must not be disposed together with the domestic waste. This appliance has to be disposed at an authorized place for recycling of electrical and electronic appliances. By collecting and recycling waste, you help save natural resources, and make sure the product is disposed in an environmental friendly and healthy way.

**⚠ WARNING** Cancer and Reproductive Harm - [www.p65warnings.ca.gov](http://www.p65warnings.ca.gov)

Distributed by  
[www.AmeraProducts.com](http://www.AmeraProducts.com)  
 Phone: (800) 608-6568  
 Fax: (409) 840-5545  
[info@ameraproducts.com](mailto:info@ameraproducts.com)

# Unpacking / Standard Accessories

1. Remove all packing material. Recycling is recommended.
2. Carefully remove the hand dryer from the shipping carton, using care not to drop the appliance.
3. Inspect carefully for any damage that may have occurred during transit. Check for any loose, missing or damaged parts. If the hand dryer is damaged or missing parts, promptly inform the dealer where you purchased it or contact World Dryer at 1-800-323-0701.

Standard items included with the hand dryer are:

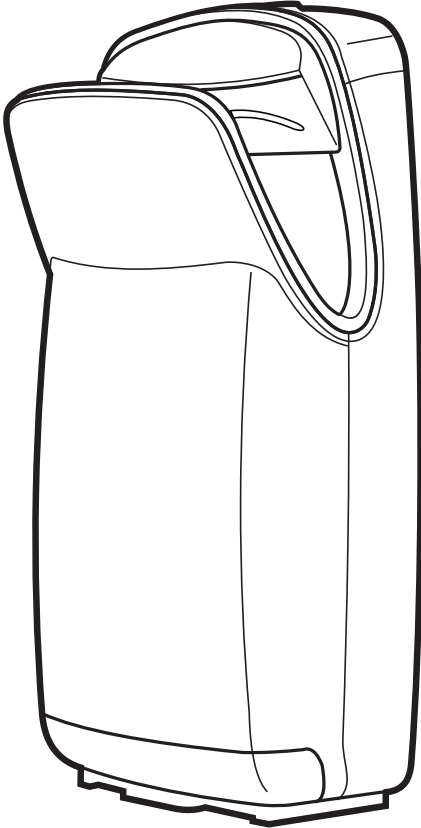

Cleaning Brush

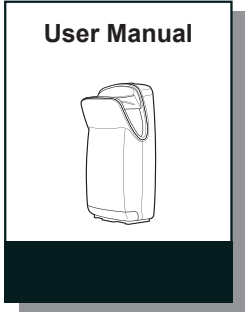

User Manual

Manual

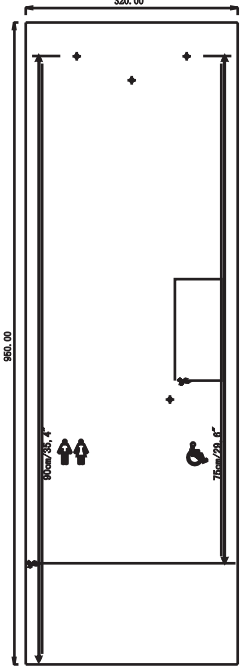

Mounting Template

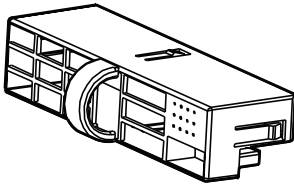

HEPA Filter Cartridge with Odor Neutralizing Tablet

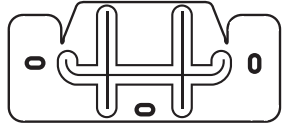

Wall Mounting Bracket with mounting anchors



# Installation

**CAUTION** Improper mounting could result in personal injury or property damage.

1. Disconnect the power source.
  2. Use the mounting template provided to mark the locations for the (4) wall mounting anchors to attach the wall mounting bracket to the wall.
  3. It is recommended that at least 1 of the 4 mounting anchors for the unit be fastened into a wall stud or support.
  4. To use the hollow wall anchors included with the wall mounting kit, pre-drill the wall in the marked locations using a 5/16" (8mm) drill, insert the plastic anchors and tap flush to the wall.
  5. Complete the attachment of the wall mounting bracket to the wall with the (4) mounting anchors using a No. 25 torx screwdriver.
  6. Remove the small panel at lower rear of hand dryer for accessing the connection terminal block.
  7. Connect power supply wiring to terminal block and secure with cable clamp provided.
  8. Replace and secure access panel.
- NOTE:** This model hand dryer is a double-insulated appliance and does not require an external ground connection.
9. Hang the hand dryer on the bracket. Remove water collection tray from bottom of dryer, and complete the attachment of the dryer with the 4th anchor.
  10. Replace the water collection tray.
  11. Connect the power source.

## How to Use

1. The hand dryer will start automatically when hands are inserted.
2. Slowly move your hands up and down through the air stream for 10 – 12 seconds.
3. The hand dryer will stop automatically after hands are removed.

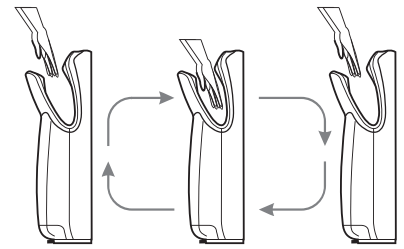

## Dryer Controls

The hand dryer is equipped with an ON/OFF Power Switch and Speed Control Switch for quieter operation if desired. The factory setting for the Speed Control Switch is "HIGH". Both the ON / OFF Power Switch and Speed Control Switch are located inside the dryer - above the water collection tray. To access, remove the water collection tray and intake air pre-filter and locate the ON / OFF Power Switch and Speed Control Switch as shown in the figure below.

Note: The hand dryer includes an anti-vandal lock for securing the water collection tray and HEPA filter. The lock is located immediately below the water collection tray. To remove the water collection tray or HEPA filter, slide the lock to the left to the "unlocked" position. After servicing, slide the lock to the right to the "locked" position.

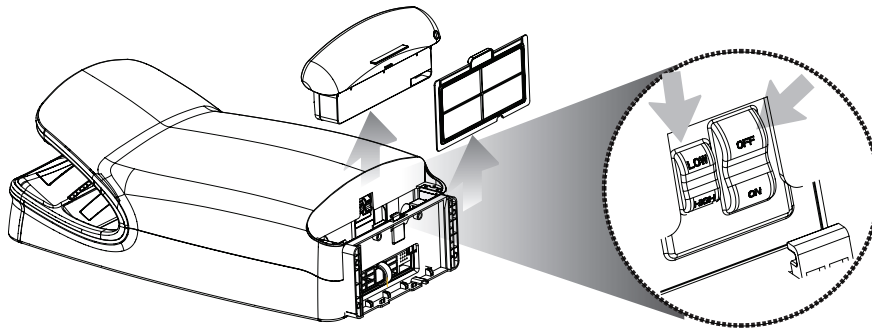

### LED Display

The LED display provides information about the operation and servicing needs of the hand dryer.

- LED's 1 through 4 flash Green when dryer is in operation.
- LED 5 is solid Green when dryer is in standby mode; solid Blue when dryer is in operation.
- LED 6 is unlit during normal operation; flashing Red when HEPA filter requires replacement.
- LED 7 is unlit during normal operation; solid Blue when water collection tank needs emptying.

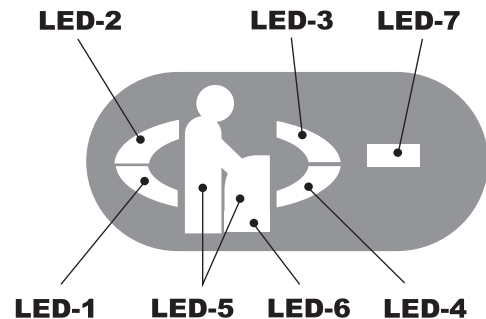

## Maintenance and Cleaning Instructions

Distributed by  
[www.Ameraproducts.com](http://www.Ameraproducts.com)  
Phone: (800) 608-6568  
Fax: (409) 840-5545  
[info@ameraproducts.com](mailto:info@ameraproducts.com)

### Cleaning

- **Important:** The sensor lenses located on front and rear sides of the drying cavity should be routinely cleaned to maintain proper operation.
- All surfaces of the hand dryer can be cleaned with a soft cloth and non-abrasive, non-caustic cleaning solution.
- Provided cleaning brush should be used for cleaning the drain hole in the bottom of the drying cavity.

### Maintenance

#### Emptying the Water Collection Tray

1. The water collection tray will fill with water with hand dryer use.
2. Regularly check the water tank status on the LED display panel. The LED Display will indicate when the water collection tray is full and needs emptying.
3. If water collection tray is not emptied when full, the collection tray will overflow onto the floor. High washroom traffic may require more frequent emptying of the water collection tray.
4. For optimum hygiene, routinely clean the water collection tray with a non-brasive, non-caustic cleaning solution.

### HEPA Filter with Odor Neutralizing Tablet

1. This hand dryer is equipped with removable intake air pre-filter and a replaceable cartridge containing a HEPA filter and an odor neutralizing tablet.
2. Regularly check the filter status on the LED display panel. The LED display panel will indicate when the HEPA filter requires replacement. High washroom traffic may require more frequent replacement of the HEPA filter.
3. The removable intake air pre-filter can be cleaned and re-used.

**Caution:** Failure to replace a used / dirty HEPA filter can cause overheating of the hand dryer's motor and may invalidate your warranty rights.

Replacement filters can be purchased through your dealer where you purchased the hand dryer or through World Dryer Corporation. Please contact World Dryer Corporation at 1-800-323-0701.

## Troubleshooting Chart

Problem	Action
The hand dryer fails to start.	Check the power supply is turned on.
	Check the hand dryer's internal power switch (remove water tray to access - see Dryer Controls section in this manual) is switched on.
	Clean sensor area inside drying cavity.

## Limited Warranty

**World LIMITED FIVE – YEAR WARRANTY.** World Air Hand Dryer, Model covered in this manual, is warranted by World Dryer Corporation to the original user against defects in workmanship or materials under normal use for 5 years after date of purchase excluding normal wear and tear, or expendable parts such as HEPA filters, motor brushes, etc. Any part which is determined to be defective in material or workmanship and returned to an authorized service location, as World designates, shipping costs prepaid, will be, as the exclusive remedy, repaired or replaced at World's option. For limited warranty claim procedures, see PROMPT DISPOSITION below. This limited warranty gives purchasers specific rights from jurisdiction to jurisdiction.

**LIMITATION OF LIABILITY.** To the extent allowable under applicable law, World's liability for consequential and incidental damages is expressly disclaimed. World's liability in all events is limited to and shall not exceed the purchase price paid.

**WARRANTY DISCLAIMER.** World has made a diligent effort to provide product information and illustrate the products in this literature accurately; however, such information and illustrations are for the sole purpose of identification, and do not express or imply a warranty that the products are MERCHANTABLE, or FIT FOR A PARTICULAR PURPOSE, or that the products will necessarily conform to the illustrations or descriptions. Except as provided below, no warranty or affirmation on fact, expressed or implied, other than as stated in the "LIMITED WARRANTY" above is made or authorized by World.

**PRODUCT SUITABILITY.** Many jurisdictions have codes and regulations governing sales, construction, installation, and/or use of products for certain purposes, which may vary from those in neighboring areas. While World attempts to assure that the products comply with such codes, it cannot guarantee compliance, and can not be responsible for how the product is installed or used. Before purchase and use of a product, review the product application, and all applicable national and local codes and regulations, and be sure that the product, installation, and use will comply with them.

Certain aspects of disclaimers are not applicable to consumer products; e.g., (a) some jurisdictions do not allow the exclusion or limitation of incidental or consequential damages, so the above limitation or exclusion may not apply to you; (b) also, some jurisdictions do not allow a limitation on how long an implied warranty lasts, consequentially the above limitation may not apply to you; and (c) by law, during the period of this Limited Warranty, and implied warranties of implied merchantability or fitness for particular purpose applicable to consumer products purchased by consumers, may not be excluded or otherwise disclaimed. Distributed by World Dryer Corporation, Berkeley, Illinois 60163 U.S.A.

**PROMPT DISPOSITION.** World will make a good faith effort for prompt correction or other adjustment with respect to any product which proves to be defective within limited warranty. For any product believed to be defective within limited warranty, first write or call dealer from whom the product was purchased. Dealer will give additional directions. If unable to resolve satisfactorily, write to World at address below, giving dealer's name, address, date, and number of dealer's invoice, and describing the nature of defect. Title and risk of loss pass to buyer on delivery to common carrier. If product was damaged in transit to you, file claim with carrier.

